



Tungsten Carbide Tools

Tungsten Carbide Burrs



Safety



TC Burrs perform best between 350-600m/min, this giving the optimum balance between stock removal, surface finish, cutting temperature.

**NB! Excess speed is dangerous and may result in chipping and breaking
NEVER USE TC BURRS AT SPEEDS IN EXCESS of 600m/min!
Burrs are direction sensitive.
Use in accordance to ANSI B7.1.**

TC Burrs are available in a range of different cutting teeth.

| DESCRIPTION | Size D1-L1-D2 | |
|---|--------------------------------|--|
| Shape A – Cylindrical (Excluding end-cut) | 06-16-06 | |
| | 10-20-06 | |
| | 12-25-06 | |
| Shape B – Cylindrical (Including end-cut) | 03-12-03 | |
| | 06-16-06 | |
| | 10-20-06 | |
| Shape C – Cylindrical Ball Nose | 12-25-06 | |
| | 16-25-06 | |
| | 12-25-06 with 220mm long shank | |
| | 06-16-06 | |
| | 10-20-06 | |
| Shape D-Ball | 06-06-06 | |
| | 10-10-06 | |
| | 12-12-06 | |
| Shape F-Round Tree | 06-16-06 | |
| | 10-20-06 | |
| | 12-25-06 | |
| Shape G-Pointed Tree | 06-16-06 | |
| | 10-20-06 | |
| | 12-25-06 | |
| | 12-25-06 with 220mm long shank | |
| Shape L-Ball Nose Cone 14 degree | 10-30-06 | |
| | 12-30-06 | |
| Shape M-Cone | 06-16-06 | |
| | 10-20-06 | |
| | 12-25-06 | |
| Shape N-Inverted Cone-End | 06-06-06 | |
| | 12-12-06 | |

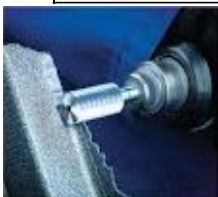
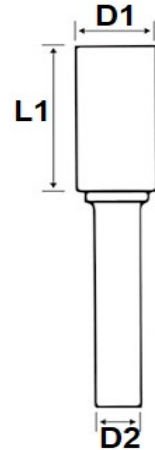

Typhoon TC Burrs are available in assorted sets.

